

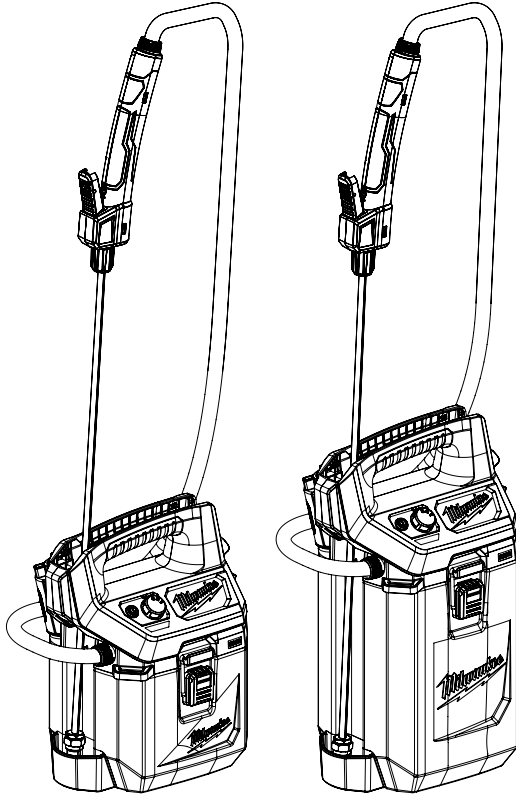



## OPERATOR'S MANUAL



Cat. No.  
M12 BHCS, 49162761, 49162762

### M12™ 4 LITRE AND 7 LITRE HANDHELD CHEMICAL SPRAYER

 **WARNING**

 To reduce the risk of injury, user must read and understand operator's manual.

## IMPORTANT SAFETY INSTRUCTIONS

**⚠ WARNING** Read all safety warnings, instructions, illustrations and specifications provided with this power tool. Failure to follow all instructions listed below may result in electric shock, fire and/or serious injury. Save all warnings and instructions for future reference.

The term "power tool" in the warnings refers to your mains-operated (corded) power tool or battery-operated (cordless) power tool.

### WORK AREA SAFETY

- Keep work area clean and well lit. Cluttered or dark areas invite accidents.
- Do not operate power tools in explosive atmospheres, such as in the presence of flammable liquids, gases or dust. Power tools create sparks which may ignite the dust or fumes.
- Keep children and bystanders away while operating a power tool. Distractions can cause you to lose control.

### ELECTRICAL SAFETY

- Power tool plugs must match the outlet. Never modify the plug in any way. Do not use any adapter plugs with earthed (grounded) power tools. Unmodified plugs and matching outlets will reduce risk of electric shock.
- Avoid body contact with earthed or grounded surfaces, such as pipes, radiators, ranges and refrigerators. There is an increased risk of electric shock if your body is earthed or grounded.
- Do not expose power tools to rain or wet conditions. Water entering a power tool will increase the risk of electric shock.
- Outdoor use. Do not expose to rain; store indoors.
- Do not abuse the cord. Never use the cord for carrying, pulling or unplugging the power tool. Keep cord away from heat, oil, sharp edges or moving parts. Damaged or entangled cords increase the risk of electric shock.
- When operating a power tool outdoors, use an extension cord suitable for outdoor use. Use of a cord suitable for outdoor use reduces the risk of electric shock.
- If operating a power tool in a damp location is unavoidable, use a residual current device (RCD) protected supply. Use of a RCD reduces the risk of electric shock.

### PERSONAL SAFETY

- Stay alert, watch what you are doing and use common sense when operating a power tool. Do not use a power tool while you are tired or under the influence of drugs, alcohol or medication. A moment of inattention while operating power tools may result in serious personal injury.
- Use personal protective equipment. Always wear eye protection. Protective equipment such as a dust mask, non-skid safety shoes, hard hat or hearing protection used for appropriate conditions will reduce personal injuries.
- Prevent unintentional starting. Ensure the switch is in the off-position before connecting to power source and/or battery pack, picking up or carrying the tool. Carrying power tools with your finger on the switch or energising power tools that have the switch on invites accidents.
- Do not overreach. Keep proper footing and balance at all times. This enables better control of the power tool in unexpected situations.
- Dress properly. Do not wear loose clothing or jewellery. Keep your hair and clothing away from moving parts. Loose clothes, jewellery or long hair can be caught in moving parts.

- Do not let familiarity gained from frequent use of tools allow you to become complacent and ignore tool safety principles. A careless action can cause severe injury within a fraction of a second.
- Remove any adjusting key or wrench before turning the power tool on. A wrench or a key left attached to a rotating part of the power tool may result in personal injury.
- If devices are provided for the connection of dust extraction and collection facilities, ensure these are connected and properly used. Use of dust collection can reduce dust-related hazards.

### POWER TOOL USE AND CARE

- Do not force the power tool. Use the correct power tool for your application. The correct power tool will do the job better and safer at the rate for which it was designed.
- Do not use the power tool if the switch does not turn it on and off. Any power tool that cannot be controlled with the switch is dangerous and must be repaired.
- Disconnect the plug from the power source and/or remove the battery pack, if detachable, from the power tool before making any adjustments, changing accessories, or storing power tools. Such preventive safety measures reduce the risk of starting the power tool accidentally.
- Store idle power tools out of the reach of children and do not allow persons unfamiliar with the power tool or these instructions to operate the power tool. Power tools are dangerous in the hands of untrained users.
- Maintain power tools and accessories. Check for misalignment or binding of moving parts, breakage of parts and any other condition that may affect the power tool's operation.
- Keep cutting tools sharp and clean. Properly maintained cutting tools with sharp cutting edges are less likely to bind and are easier to control.
- Use the power tool, accessories and tool bits etc. in accordance with these instructions, taking into account the working conditions and the work to be performed. Use of the power tool for operations different from those intended could result in a hazardous situation.
- Keep handles and grasping surfaces dry, clean and free from oil and grease. Slippery handles and grasping surfaces do not allow for safe handling and control of the tool in unexpected situations.

### BATTERY TOOL USE AND CARE

- Recharge only with the charger specified by the manufacturer. A charger that is suitable for one type of battery pack may create a risk of fire when used with another battery pack.
- Use power tools only with specifically designated battery packs. Use of any other battery packs may create a risk of injury and fire.
- When battery pack is not in use, keep it away from other metal objects, like paper clips, coins, keys, nails, screws or other small metal objects, that can make a connection from one terminal to another. Shorting the battery terminals together may cause burns or a fire.
- Under abusive conditions, liquid may be ejected from the battery; avoid contact. If contact accidentally occurs, flush with water. If liquid contacts eyes, additionally seek medical help. Liquid ejected from the battery may cause irritation or burns.
- Do not use a battery pack or tool that is damaged or modified. Damaged or modified batteries may exhibit unpredictable behaviour resulting in fire, explosion or risk of injury.

- **Do not expose a battery pack or tool to fire or excessive temperature.** Exposure to fire or temperature above 130°C (265°F) may cause explosion.
- **Follow all charging instructions and do not charge the battery pack or tool outside the temperature range specified in the instructions.** Charging improperly or at temperatures outside the specified range may damage the battery and increase the risk of fire.

## SERVICE

- **Have your power tool serviced by a qualified repair person using only identical replacement parts.** This will ensure that the safety of the power tool is maintained.
- **Never service damaged battery packs.** Service of battery packs should only be performed by the manufacturer or authorised service providers.

## SPECIFIC SAFETY RULES FOR HANDHELD SPRAYERS

- **⚠ WARNING** Risk of fire or explosion. Do not spray flammable liquids such as gasoline. Do not use tool around spark, flame, or smoke. Chemical may ignite.
- **Use the correct tank for your application.** These products are suitable for pesticide applications (such as insecticides, fungicides, or herbicides, fertilisers) and water supply applications, when used in accordance with these instructions and those applicable to the chemicals.
- **Do not use bleach, caustic (alkali) self-heating or corrosive (acidic) liquids in this sprayer. Do not pour hot or boiling liquids into the tank.** These can corrode metal parts or weaken the tank and hose.
- **Always fill the tank with water first, before adding chemicals.**
- **Electric shock hazard. Never spray toward electrical outlets.**
- **Spray area must be well ventilated to avoid hazardous fumes build-up.**
- **Avoid spraying on windy days.** Spray can be blown onto people, plants, or objects that should not be sprayed.
- **Do not store chemicals in the tank.** Chemicals can degrade seals and hoses. Drain and clean after each use.
- **Remove gloves before handling battery packs.** Chemicals are harmful to plastics.
- **Maintain your power tool.** Thoroughly inspect inside and outside and examine all components before each use. Check for cracked and deteriorated hoses, leaks, clogged nozzles, and missing or damaged parts. If damaged, have the power tool repaired before use. Many accidents are caused by poorly maintained power tools.
- **Always unplug the charger and remove the battery pack from the charger or tool before performing any maintenance, storing, or draining the tool.** Never disassemble the tool, battery pack or charger. Contact a MILWAUKEE® service facility for ALL repairs.
- **Do not eat or smoke while handling or operating the tool.** After use, wash with hot, soapy water to help reduce the risk of health hazards due to exposure to chemicals.
- **Always use common sense and be cautious when using tools.** It is not possible to anticipate every situation that could result in a dangerous outcome. Do not use this tool if you do not

understand these operating instructions or you feel the work is beyond your capability; contact MILWAUKEE® Tool or a trained professional for additional information or training.

- **Maintain labels and nameplates. These carry important information.** If unreadable or missing, contact a MILWAUKEE® service facility for a replacement.

**⚠ WARNING** Some dust created by power sanding, sawing, grinding, drilling, and other construction activities contains chemicals known to cause cancer, birth defects or other reproductive harm. Some examples of these chemicals are:

- lead from lead-based paint
- crystalline silica from bricks and cement and other masonry products, and
- arsenic and chromium from chemically-treated lumber.

Your risk from these exposures varies, depending on how often you do this type of work. To reduce your exposure to these chemicals: work in a well-ventilated area, and work with approved safety equipment, such as those dust masks that are specially designed to filter out microscopic

**READ AND SAVE ALL INSTRUCTIONS FOR FUTURE USE.**

**THE PRODUCT IS FOR HOUSEHOLD USE.**

## ADDITIONAL BATTERY SAFETY RULES

**⚠ WARNING** To reduce the risk of fire, personal injury, and product damage due to a short circuit, never immerse your tool, battery pack or charger in fluid or allow a fluid to flow inside them. Corrosive or conductive fluids, such as seawater, certain industrial chemicals, and bleach or bleach-containing products, etc., can cause a short circuit.

**⚠ WARNING** Do not charge non-rechargeable batteries.

## SYMBOLGY

-  Volts
-  Direct Current
-  Read operator's manual
-  Wear eye protection.
-  Wear gloves.
-  Wear dust mask.
-  Wear protective clothing.
-  Do not spray flammable liquids.

 Regulatory Compliance mark (RCM). This product meets applicable regulatory requirements.

 Do not dispose of electric tools together with household waste material. Electric tools and electronic equipment that have reached the end of their life must be collected separately and returned to an environmentally compatible recycling facility.

## FUNCTIONAL DESCRIPTION

## SPECIFICATIONS

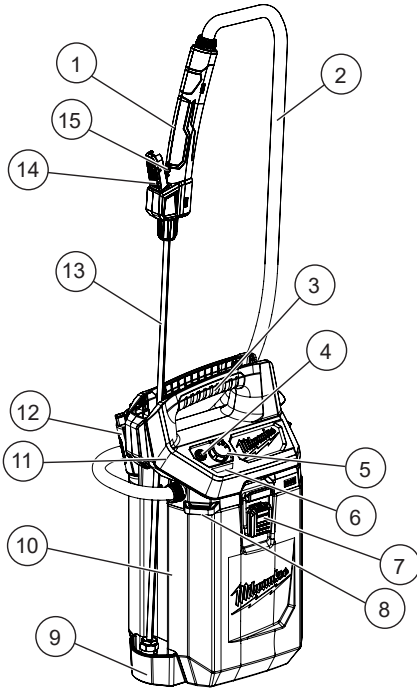

- |                           |                                   |
|---------------------------|-----------------------------------|
| 1. Trigger handle         | 9. Wand storage pocket            |
| 2. Hose                   | 10. Tank                          |
| 3. Carry handle           | 11. Powered sprayer head          |
| 4. Power button           | 12. Fill/measuring cup (obscured) |
| 5. Flow rate dial         | 13. Spray wand                    |
| 6. Fuel gauge             | 14. Trigger                       |
| 7. Tank latches           | 15. Trigger lock-off              |
| 8. Shoulder strap anchors |                                   |

Cat. No.....	M12 BHCS
Volts.....	12V DC
Battery Type.....	M12™
Charger Type.....	M12™
4 Litre Tank Cat. No.....	49162761
7 Litre Tank Cat. No.....	49162762
Flow Rate.....	0.38 to 1.14 LPM
Full Weight (4 Litre) .....	7.3 kg
Full Weight (7 Litre) .....	11.3 kg
Recommended Ambient Operating Temperature.....	0°C to 51°C
Sound pressure level.....	57 dB(A)
Uncertainty K.....	3 dB(A)
Sound power level.....	68 dB(A)
Uncertainty K.....	3 dB(A)
Vibration emission value $a_h$ .....	0.29 m/s <sup>2</sup>
Uncertainty K.....	1.5 m/s <sup>2</sup>

**⚠ WARNING** The vibration and noise emission level given in this information sheet has been measured in accordance with a standardised test and may be used to compare one tool with another. It may be used for a preliminary assessment of exposure.

The declared vibration emission level represents the main applications of the tool. However if the tool is used for different applications, with different accessories or is poorly maintained, the vibration emission may differ. This may significantly increase the exposure level over the total working period.

An estimation of the level of exposure to vibration should also take into account the times when the tool is switched off or when it is running but not actually doing the job. This may significantly reduce the exposure level over the total working period.

Identify additional safety measures to protect the operator from the effects of vibration and/or noise such as: maintain the tool and the accessories, keep the hands warm, organisation of work patterns.

## ASSEMBLY

- Always wear personal protective equipment (PPE) according to the chemical manufacturer's instructions. Always wear proper eye protection marked to comply with AS/NZS 1337.1.
- When using an attachment with larger capacity battery packs or larger capacity tanks, use the shoulder strap to reduce user fatigue and help in maintaining control of the tool during use.
- Always turn off the tool and remove the battery pack before installing or changing accessories.

### Attaching the Loops to the Sprayer

(For use with Cat. No. M12 BHCS)

To install the strap:

1. Remove the battery pack.
2. Remove the powered head from the tank.
3. Position the 3-bar slide less than 25 mm from the d-ring of the strap.
4. Insert the strap through the first hole of the metal 3-bar slide and weave the strap over the centre of the 3-bar slide into the second hole of the metal 3-bar slide.
5. Insert the fabric end of the strap into the anchor point of the tool.
6. Take the end of the strap and weave through the second hole of the metal 3-bar slide and then into the first hole.
7. Take the remaining fabric end and weave the strap through the 3-bar slide as shown.
8. Repeat the steps for the other anchor point located on the opposite side of the tool.

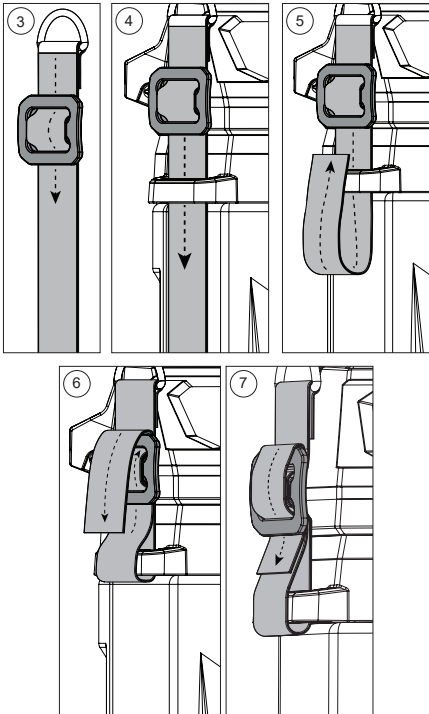

### Attaching the Shoulder Strap

(For use with Cat. No. M12 BHCS)

To install the strap:

1. Remove the battery pack.
2. Remove the powered head from the tank.
3. Clip the shoulder strap to the d-ring on each anchor point of the tool.

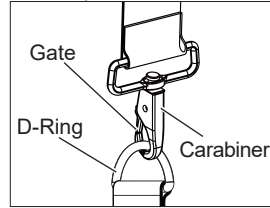

To wear the strap:

1. Put either right or left arm and head through the strap.
2. Adjust the strap to fit comfortably.
3. Slide the shoulder pad to the appropriate position.

To unclip the strap:

1. Hold the tool by the handle.
2. Grip the carabiner and unclip by pushing in the gate and it sliding off the bevel. Do this for both anchor points on the tool.

**WARNING** Recharge only with the charger specified for the battery. For specific charging instructions, read the operator's manual supplied with your charger and battery.

### Inserting/Removing the Battery

To insert the battery, slide the pack into the body of the tool. Make sure it latches securely into place.

**WARNING** Only use accessories specifically recommended for this tool. Others may be hazardous.

To remove the battery, push in the release buttons and pull the battery pack away from the tool.

**WARNING** Always lock the trigger or remove the battery pack any time the tool is not in use.

### Connecting the Spray Wand to the Trigger Handle

1. Insert the spray wand into the trigger handle until firmly seated.
2. Slide the nut onto the threaded coupling and hand tighten securely.
3. Pull on the spray wand to be certain it is properly secured.
4. Place the assembled trigger handle back into the wand storage pocket.

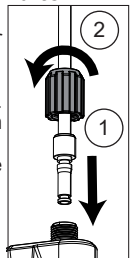

### Connecting the Nozzles

Select and screw on nozzle by job type. When using the adjustable nozzle, adjust spray pattern as desired by tightening/loosening the nozzle.

## Filling the Tank

**⚠WARNING** Remove powered sprayer head from tank before filling or cleaning. Follow chemical manufacturer's instructions for mixing, use, and handling of chemicals. Always fill the tank with water first, before adding chemicals.

1. Remove battery pack.
2. Remove the tank from the powered sprayer head and set on a level surface away from the powered sprayer head to prevent exposure to harsh chemicals.
3. Unscrew and remove the tank cap; ensure strainer is seated in opening. A removable strainer prevents debris from entering the tank that can clog or damage the pump.
4. Fill the tank. Use the volume markings on the side of the tank as a guide.
5. Reinstall the tank cap.
6. Reinstall the tank, securing the tank latches.
7. Label tank contents accordingly during each use. Only put recommended liquids in tank.

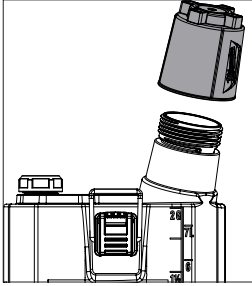

## Installing the Tank

1. Remove battery pack.
2. Secure tank to the powered sprayer head with front and back tank latches; ensuring the powered sprayer head is firmly seated, and all seals are aligned.

## OPERATION

**⚠WARNING** To reduce the risk of injury, always wear personal protective equipment (PPE) according to the chemical manufacturer's instructions. Always wear proper eye protection marked to comply with AS/NZS 1337.1.

### Fuel Gauge

To determine the amount of charge left in the battery, turn the tool **ON**. The Fuel Gauge will light up for 2-3 seconds. When less than 10% of charge is left, 1 light on the fuel gauge will flash 4 times.

To signal the end of charge, 1 light on the fuel gauge will flash 8 times and the tool will not run. Charge the battery pack.

If the battery becomes too hot, the fuel gauge lights will flash and the tool will not run. Allow the battery to cool down.

### Adjusting the Flow Rate

Select the desired flow from Low (1) to High (3), depending on the job and the chemical manufacturer's instructions.

Setting	Pressure	Flow Rate
1	Low	0.38 LPM
2	Medium	0.76 LPM
3	High	1.14 LPM

## Trigger Lock-Off

To avoid accidental spraying, engage the trigger lock-off.

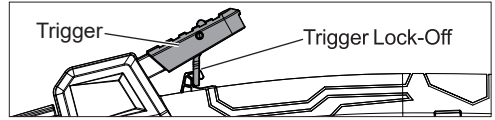

1. Push down the lock-off at the end of the trigger.
2. Hook the lock-off tab under the trigger.
3. To release, push the lock-off tab back into the trigger, and unhook.

## Turning the Sprayer ON/OFF

1. Before turning **ON**, check for any leaks around the tank, spray wand, hose, and other components before use.
2. To turn the sprayer **ON**, press the power button.
3. To start the flow of liquid at the spray wand, press the trigger. The sprayer may be operated with trigger handle attached to carrying handle.
4. To stop the flow of liquid at the spray wand, release the trigger.
5. To turn the sprayer **OFF**, press the power button again.

**NOTE:** Be aware some spray material may remain inside the spray wand and drip out. To drain, turn off the tool, then pull the trigger and point the tool down until dripping stops.

## Spraying

•Pull the trigger and begin sweeping the nozzle from side to side, coating the desired surface evenly in accordance with chemical manufacturer's instructions.

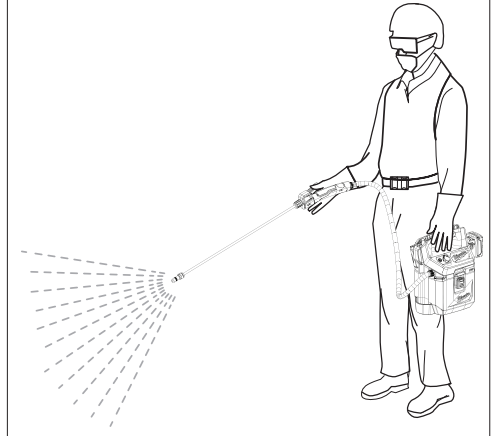

**NOTE:** Make sure to stand far enough from the object being sprayed to prevent the spray from splashing back onto you.

- Always empty, clean, and drain the tank after every use as directed in the Maintenance section.
- Thoroughly clean the sprayer before storing or before switching to a different chemical.
- When you are finished with the sprayer, thoroughly wash your hands and any area where skin has been exposed to the spray.



**WARNING** Before using any chemicals and/or solutions, read and follow all original manufacturer instructions. Read all Safety Data Sheets (SDS) and container labels provided with the chemical. Chemicals can cause serious bodily injury, and/or property damage. Wear personal protective equipment (PPE) according to the chemical manufacturer's instructions. Always wear eye protection.

## MAINTENANCE

### Maintaining Tool

Keep your tool, battery pack and charger in good repair by adopting a regular maintenance program. Inspect your tool for issues such as undue noise, misalignment or binding of moving parts, breakage of parts, or any other condition that may affect the tool operation. Return the tool, battery pack, and charger to a **MILWAUKEE**® service facility for repair. After six months to one year, depending on use, return the tool, battery pack and charger to a **MILWAUKEE**® service facility for inspection. If the tool does not start or operate at full power with a fully charged battery pack, clean the contacts on the battery pack. If the tool still does not work properly, return the tool, charger and battery pack, to a **MILWAUKEE**® service facility for repairs.

### Cleaning

Clean dust and debris from any vents. Keep tool clean, dry and free of oil or grease. Use only mild soap and a damp cloth to clean, since certain cleaning agents and solvents are harmful to plastics and other insulated parts. Some of these include petrol, turpentine, lacquer thinner, paint thinner, chlorinated cleaning solvents, ammonia and household detergents containing ammonia. Never use flammable or combustible solvents around tools.

### Draining and Cleaning the Tank, Hose, and Spray Wand

If there is any liquid left in the tank after spraying, the tank should be drained before cleaning. Do not store chemicals in the tank. Tank must be cleaned before using another liquid. Do not mix liquids. Follow the chemical manufacturer's instructions for proper cleaning, storage and/or disposal of excess liquid.

#### To Drain:

1. Remove battery pack.
2. Remove the powered head from tank.
3. Empty the tank into a suitable container through the fill area.

**WARNING** Always wear personal protective equipment (PPE) according to the chemical manufacturer's instructions. Always wear eye protection.

#### To Clean:

1. Remove battery pack.
2. Remove the powered sprayer head from tank and set on a level surface away from the tank to prevent exposure of the powered sprayer head to harsh chemicals.
3. Fill the tank about one-third full with clean water. Replace the cap and gently slosh the water around the tank.
4. Install the tank and spray the water until the tank has been emptied. Make sure to direct the spray toward an area that will not be damaged by residue chemicals in the tank.

5. Repeat the procedure with clean water until the tank is thoroughly clean. Wash outside of nozzles and dry with a cloth.
6. Wipe the outside of the tank with a clean, dry cloth.
7. Allow all pieces to completely dry before reinstalling parts and storing the sprayer. Always reinsert strainer before replacing tank cap.

### Storage

Protect from freezing, store indoors. Store spray wand securely in wand storage pocket. Store the sprayer in a secure, well-ventilated indoor space with the tank empty.

### Repairs

For repairs, return the tool, battery pack and charger to the nearest authorised service centre.

## ACCESSORIES

**WARNING** Use only recommended accessories. Others may be hazardous.

For a complete listing of accessories, go online to [milwaukeeetool.com.au](http://milwaukeeetool.com.au) / [milwaukeeetool.co.nz](http://milwaukeeetool.co.nz) or contact a distributor.

## **WARRANTY - AUSTRALIA and NEW ZEALAND**

Please refer to Australian and New Zealand warranty supplied with tool. This warranty applies only to product sold by authorised dealers in Australia and New Zealand.

## **SERVICE - AUSTRALIA and NEW ZEALAND**

**MILWAUKEE®** prides itself in producing a premium quality product that is Nothing But Heavy Duty™. Your satisfaction with our products is very important to us! If you encounter any problems with the operation of this tool, please contact your authorised **MILWAUKEE®** dealer.

For a list of **MILWAUKEE®** dealers, guarantee or service agents please contact **MILWAUKEE®** Customer Service or visit our website.

(Australia Toll Free Telephone Number 1300 645 928)

(New Zealand Toll Free Telephone Number 0800 645 928)

or visit [milwaukeetool.com.au/milwaukeetool.co.nz](http://milwaukeetool.com.au/milwaukeetool.co.nz).

### **Milwaukee Electric Tool Corporation**

13135 West Lisbon Road, Brookfield, Wisconsin U.S.A. 53005

#### **Milwaukee Tool (Australia)**

26 - 40 Nina Link, Dandenong South,  
Victoria, 3175, Australia

#### **Milwaukee Tool (New Zealand)**

274 Church Street, Penrose,  
Auckland, 1061, New Zealand

DESIGNED BY MILWAUKEE ELECTRIC TOOL CORP.

PROFESSIONALLY MADE IN CHINA

PRINTED IN CHINA